

Quick-Start Guide

Mini Remote Wall Mount Bracket

Model: 2444B4

What's Included

- Wall Mount Bracket
- 2 Wall Anchors
- 2 Screws

Installation – New Switch Location

- 1) Align wall mount bracket on wall* and mark the mounting holes
- 2) Drill holes and install anchors
- 3) Put wall mount bracket into position and install screws (do not over-tighten)
- 4) Install wallplate (sold separately)
- 5) Snap Mini Remote into place with LED on top

To remove, wedge finger on the bottom of Mini Remote and gently pull out.

*Mini Remote is not rated for placement directly over open junction boxes. The Wall Mount Brackets are designed to easily allow multiple units to be mounted side-by-side. Use the alignment guides to "lock" them into position (Figure 1)

Installing Next to a Wired-in Switch

Note: this requires a wallplate with an additional gang.

- 1) Remove existing wallplate (Figure 2)
- 2) Attach Wall Mount Bracket to back of new multi-gang wallplate using the wallplate screws (Figure 3)
- 3) Install new wallplate on existing switch(es)
- 4) Snap Mini Remote into wallplate (Figure 4)

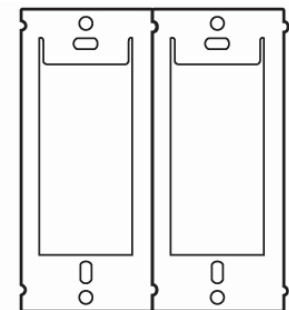
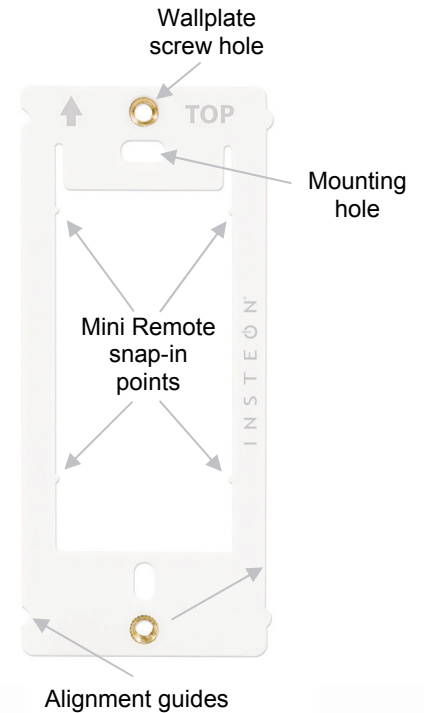

Figure 1

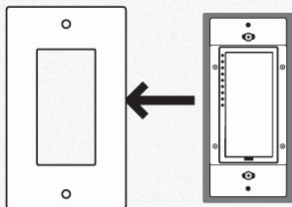

Figure 2

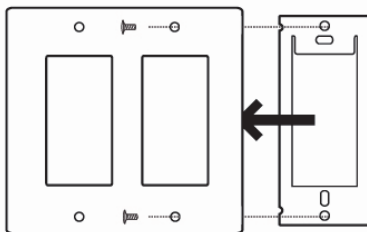

Figure 3

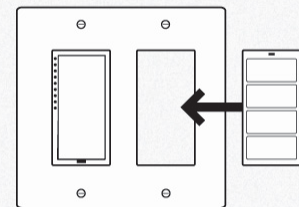

Figure 4

Tech Support

Phone: 866-243-8022

For the most up-to-date Quick Start Guide visit <http://www.insteon.com/support>